

DUAL WHEEL

R100, R110, R120 SERIES

Heavy Duty Dual Wheel

Load Capacity: 820 to 9,600 lbs.

Quality Features

- **INTEGRALLY FORGED KING PIN.**
Solid king pin is integrally forged with upper raceway using SAE-1050 quality grade steel. Used with a slotted nut to allow for proper bearing adjustment whenever necessary. Designed to be virtually indestructible!
- **HOT FORGED STEEL CONSTRUCTION**
Top plate, yoke base and bearing retainer are hot forged using SAE-1050 hardening quality steel. Raceways are precision machined for 5/8" hardened chrome steel load bearings and tapered thrust bearing.
- **FLAME HARDENED SWIVEL RACEWAY.**
All bearing raceways are flame hardened to extend service life, reduce brinelling from shock loads, and to generally improve swivel performance.

Designed for improved stability and greater load capacity while minimizing overall height.

Due to better load distribution and the "differential action" of the dual wheels, less effort is required to change directions of the swivel. Known for their dependability, durability, and longevity, these workhorses of the industry will provide many years of steady, trouble-free performance. Standard finish is industrial blue enamel.

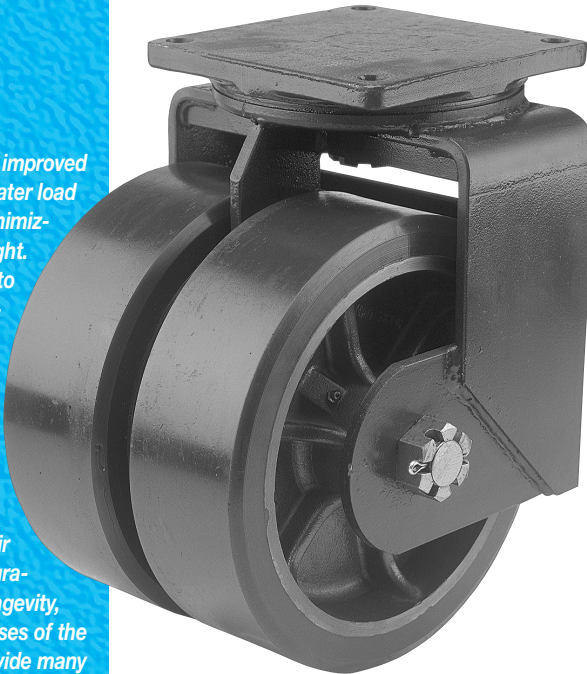

TOP PLATES

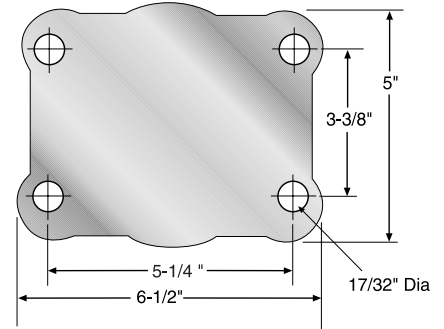

R100

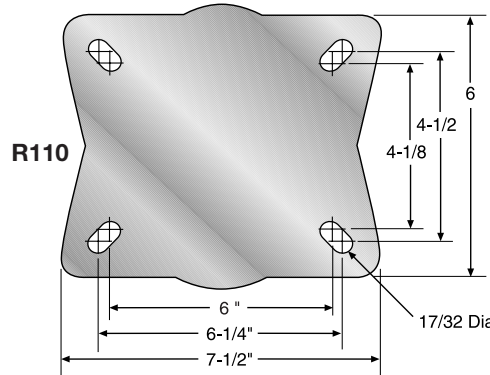

R110

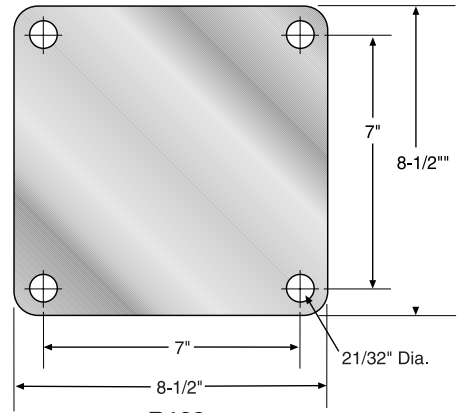

R120

88



DARNELL-ROSE
division of Evans Industries, Inc.

Wheel Selection

CAST IRON HUB

MOLD-ON RUBBER

PAGE 128

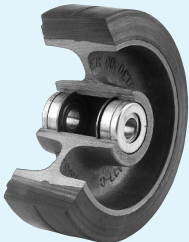

CAST IRON HUB

MOLD-ON POLYURETHANE

PAGE 136

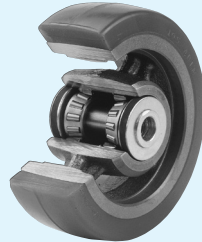

CAST IRON HUB

MOLD-ON SOFT POLY

PAGE 138

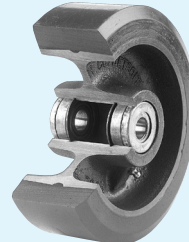

CAST IRON

PAGE 146

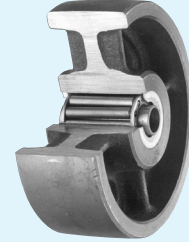

Universal Wheel Brake

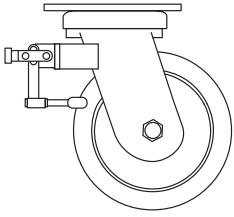

Universal Wheel Brake

The strongest, most positive foot-operated caster available. Once locked, this brake cannot be forced open under any amount of abuse until the foot bar is raised to the unlocked position. Works equally well on hard tread or soft tread wheels. Is fully adjustable to compensate for wheel wear, and is even effective on wheels with thread guards or tapered roller bearings. All parts, according to their mechanical functions, stresses, strains and wear are heat treated for longer life.

Heavy Duty Swivel Lock

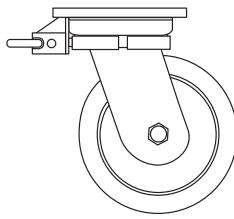

Heavy Duty Swivel Lock

This husky, plunger-type swivel lock, with cast malleable iron body can be welded to any of the heavy-duty casters.

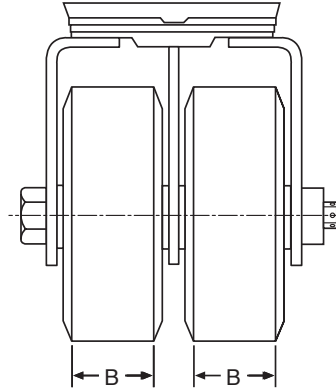
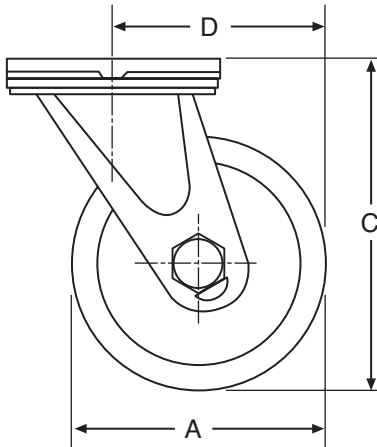

Diameter	Tread Width	Load Capacity	Wheel Material	Bearing	Swivel Part Number	Rigid Part Number	Approx. Weight	Overall Height	Swivel Radius		
		LBS					LBS				
6	2	600	SOFT POLY / CAST IRON HUB	TAPERED ROLLER	TSC-102-6-PS8	TRC-102-6-PS8	25	8-1/2	5-1/2		
		820	MOLD-ON RUBBER		TSC-102-6-RS	TRC-102-6-RS					
		2500	POLYURETHANE / CAST IRON HUB		TSC-102-6-PS	TRC-102-6-PS					
	2 1/2	960	SOFT POLY / CAST IRON HUB		TSC-100-6-PS8	TRC-100-6-PS8	30	8	5-1/4		
		1800	MOLD-ON RUBBER		TSC-101-6-PS8	TRC-101-6-PS8	29				
		3000	POLYURETHANE / CAST IRON HUB		TSC-100-6-RS	TRC-100-6-RS	29			8-1/2	5-1/2
			TSC-101-6-RS		TRC-101-6-RS	28	8			5-1/4	
		TSC-100-6-PS	TRC-100-6-PS		30	8-1/2	5-1/2				
TSC-101-6-PS	TRC-101-6-PS	29	8	5-1/4							
8	3	1600	MOLD-ON RUBBER	TAPERED ROLLER	TSC-110-8-RS	TRC-110-8-RS	51	11	6-1/2		
		1700	MOLD-ON RUBBER		TSC-120-8-RS	TRC-120-8-RS	68				
		2050	SOFT POLY / CAST IRON HUB		TSC-110-8-PS8	TRC-110-8-PS8	52				
		4000	POLYURETHANE / CAST IRON HUB		TSC-110-8-PS	TRC-110-8-PS					
		2050	SOFT POLY / CAST IRON HUB		TSC-120-8-PS8	TRC-120-8-PS8	69				
		5000	POLYURETHANE / CAST IRON HUB		TSC-120-8-PS	TRC-120-8-PS					
10	2 1/2	1600	MOLD-ON RUBBER	TAPERED ROLLER	TSC-122-10-RS	TRC-122-10-RS	66	13	7-1/2		
		2160	SOFT POLY / CAST IRON HUB		TSC-122-10-PS8	TRC-122-10-PS8	67				
		5000	POLYURETHANE / CAST IRON HUB		TSC-122-10-PS	TRC-122-10-PS					
	3	2000	MOLD-ON RUBBER		TSC-110-10-RS	TRC-110-10-RS	74	12-1/2	8		
		2400	SOFT POLY / CAST IRON HUB		TSC-120-10-RS	TRC-120-10-RS	95	13			
		5000	POLYURETHANE / CAST IRON HUB		TSC-110-10-PS8	TRC-110-10-PS8				75	12-1/2
		2400	SOFT POLY / CAST IRON HUB		TSC-110-10-PS	TRC-110-10-PS					
		2400	SOFT POLY / CAST IRON HUB		TSC-120-10-PS8	TRC-120-10-PS8	96	8			
		6000	POLYURETHANE / CAST IRON HUB		TSC-120-10-PS	TRC-120-10-PS					
		4	2800		MOLD-ON RUBBER	TSC-126-10-RS	TRC-126-10-RS	100		13	8-1/2
3120	SOFT POLY / CAST IRON HUB		TSC-126-10-PS8	TRC-126-10-PS8							
8400	POLYURETHANE / CAST IRON HUB		TSC-126-10-PS	TRC-126-10-PS	101						
11	5	3600	MOLD-ON RUBBER	TAPERED ROLLER	TSC-130-11-RS	TRC-130-11-RS	123	14-1/2	9		
		4080	SOFT POLY / CAST IRON HUB		TSC-130-11-PS8	TRC-130-11-PS8	124				
		9000	POLYURETHANE / CAST IRON HUB		TSC-130-11-PS	TRC-130-11-PS					
12	4	3200	MOLD-ON RUBBER	TAPERED ROLLER	TSC-130-12-RS	TRC-130-12-RS	114	15-1/2	9-1/2		
		3600	SOFT POLY / CAST IRON HUB		TSC-130-12-PS8	TRC-130-12-PS8	115				
		9600	POLYURETHANE / CAST IRON HUB		TSC-130-12-PS	TRC-130-12-PS					

All single wheel loads are based on 3 mph for less than 10 minutes continuous running.